

28 HUDSON ROAD SOUTHSEA PO5 1HD

CHANGE OF USE FROM A SIX BEDROOM HOUSE IN MULTIPLE OCCUPATION (CLASS C4) TO A 7 BEDROOM HOUSE IN MULTIPLE OCCUPATION (SUI GENERIS)
[NOTE AMENDE DESCRIPTION]

[HTTPS://PUBLICACCESS.PORTSMOUTH.GOV.UK/ONLINE-APPLICATIONS/APPLICATIONDETAILS.DO?ACTIVETAB=DOCUMENTS&KEYVAL=RLJYDXMOFW00](https://publicaccess.portsmouth.gov.uk/online-applications/applicationdetails.do?activetab=documents&keyval=RLJYDXMOFW00)

Application Submitted By:

Mrs Carianne Wells
Applecore PDM Ltd

On behalf of:

Birmingham
Bunked Ltd

RDD: 21st November 2022

LDD: 17th January 2023

1.0 SUMMARY OF MAIN ISSUES

- 1.1 This application is brought before Planning Committee at the request of Councillor Vernon-Jackson
- 1.2 The main issues for consideration in the determination of the application are as follows:
 - Principle of Development including compliance with policy
 - Impacts on Amenity including parking
 - Other material considerations
- 1.3 Site and surroundings
- 1.4 The application site is a two storey terraced dwelling with rooms in the roof in a predominately residential area.
- 1.5 The Proposal
- 1.6 The Applicant has sought planning permission for the change of use of the dwelling from the current lawful use of as a HMO with up to six individuals living together to allow up to 7 individuals to live together as an HMO. This change in occupancy will involve the repurposing of internal rooms but no external operational development forms part of this application.
- 1.7 Planning History
- 1.8 19/01398/FUL: Change of use from purposes falling within Class C4 (house in multiple occupation) to a 7 bedroom house in multiple occupation (sui generis).
- 1.9 A non-determination appeal (APP/Z1775/W/20/3253373) was submitted and dismissed on 3rd November 2021. The Inspectors concluding comments where: *"I conclude that the change of use has resulted in unsatisfactory living conditions for the occupiers and represents an over intensive use of the property. Accordingly, in this respect, the development conflicts with Policy PCS23 of The Portsmouth Plan Portsmouth's Core Strategy (2012) (the Core Strategy) which, amongst other things, requires that new development provides a good standard of living environment for future occupiers. This policy is consistent with paragraph 130 f) of the National Planning Policy Framework (the*

Framework) which requires developments to create places with a high standard of amenity for existing and future users, and with which the development therefore also conflicts."

- 1.10 Following this appeal decision, the applicant has proposed changes to the internal layout, primarily relating to the ground and first floor shower room. This change to the layout has resulted in all of the bedrooms now achieving over 10m² in area. As such the lower threshold has been met for the combined living space, as discussed below. Reviewing Para 11 of the Inspectors decision, this matter was examined, stating that *"Although the floor plans are not annotated with room sizes, the main parties accept that the size of the bedrooms in the property all exceed the minimum standard set out in the SPD and that 4 of the rooms exceed 10 m². I have no reason to consider otherwise. However, the SPD allows for a reduction in the communal area only where all the bedrooms are of 10 m² or more, which is not the case with the appeal property. The lack of adequate communal space impacts particularly on the occupiers of the 3 smallest bedrooms. Accordingly, the over provision of personal space does not compensate for the under provision of communal space"*. It is therefore considered that the amended layout and increased size of the bedrooms would result in an internal layout which now meets the HMO SPD space standards in regard to the combined living spaces and bedrooms.

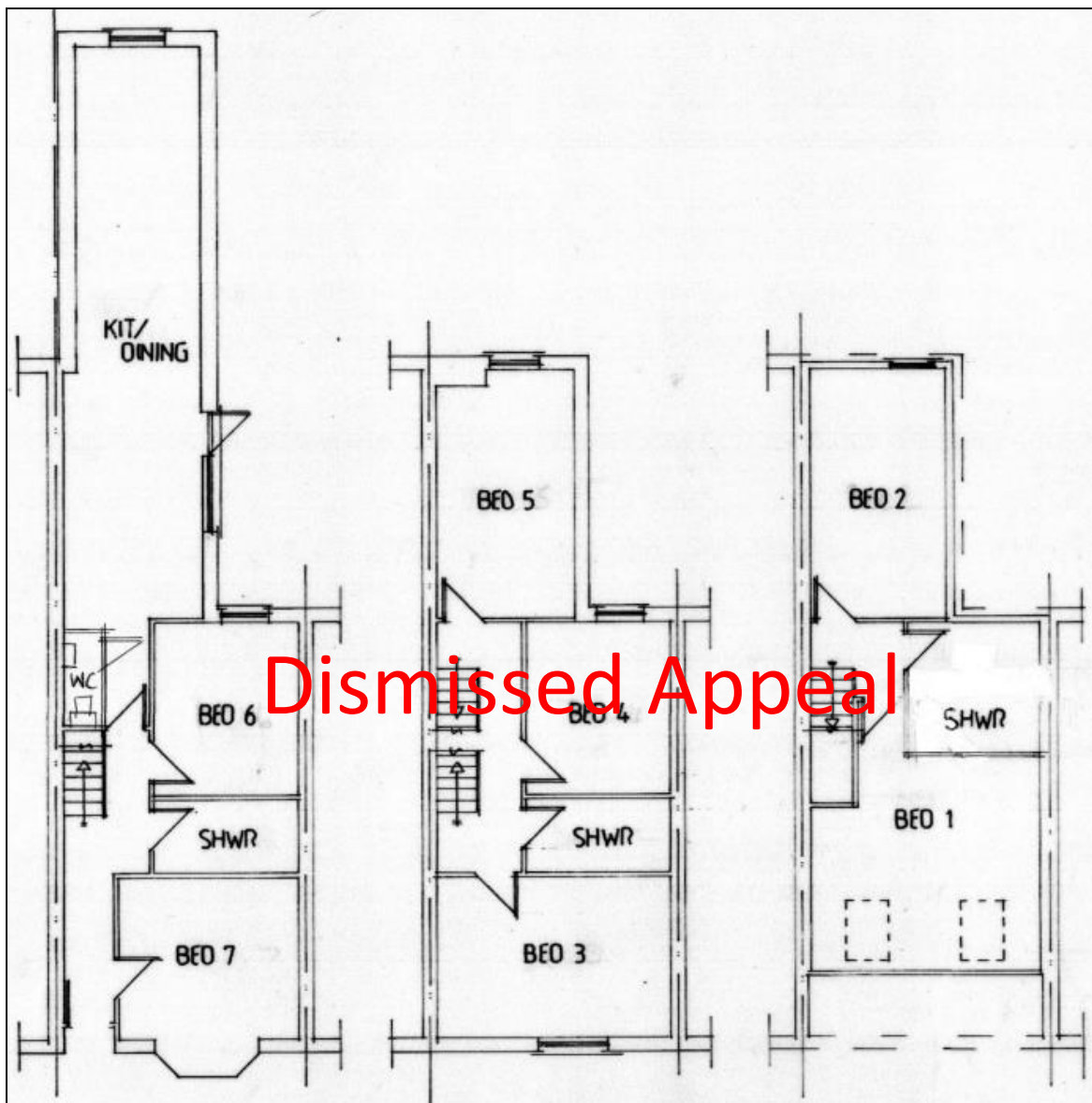

Figure 1 Floorplans of the dismissed appeal

- 1.11 As set out below the LPA has also received a number of Appeal Decisions on the question over if the increased occupancy in a HMO and results in material change of use. It is noted that within the above Appeal Decision the inspector did not address this matter.

2.0 POLICY CONTEXT

- 2.1 In addition to the aims and objectives of the National Planning Policy Framework (2021), the relevant policies within the Portsmouth Plan (2012) would include: PCS17 (Transport), PCS20 (Houses in Multiple Occupation) and PCS23 (Design and Conservation).
- 2.2 Guidance for the assessment of applications that is relevant to the application includes The Parking Standards and Transport Assessments Supplementary Planning Document (2014), The Technical Housing Standards - nationally described space standards (2015), The Solent Recreation Mitigation Strategy (2017), The Updated Nutrient Neutral Mitigation Strategy (2022), and The Houses in Multiple Occupation (HMOs) Supplementary Planning Document (2019) ('the HMO SPD')

3.0 CONSULTATIONS

- 3.1 Private Sector Housing: The City Council Private Sector Housing team advise that this property would require to be licenced under Part 2, Housing Act 2004.

4.0 REPRESENTATIONS

- 4.1 One representation has been received from a local resident raising the following concerns:
- a) No significant changes have occurred since the previous appeal; and
 - b) Question over need for the additional occupancy.

5.0 COMMENT

- 5.1 The main issues to consider in the determination of this application is whether the proposal is acceptable in principle.
- 5.2 Principle
- 5.3 The HMO SPD has been published to provide a tool for addressing the recognised impacts that HMO's may have in Portsmouth, most notably in relation to the residential amenity, both for occupiers of HMO's and neighbouring properties and housing mix of certain communities. Two of the key matters of principles explained in the HMO SPD are the assessment of housing mix to ensure balanced communities and the application of minimum room sizes, reflecting those in force as part of the private sector housing licencing regime, to ensure an appropriate living environment for future residents.
- 5.4 In this case the application site is already in lawful use as an HMO and the application has been made to recognise the intention to increase its occupation by 1 occupant. As such the application is not considered, on its individual facts to create any material impact on the balance of the community in the area. The HMO SPD suggests a threshold of 10% of dwellings in any area of 50m radius as a maximum proportion of HMO dwellings to C3, single household, dwellings. As the minor increase in occupancy does not change this mix of dwellings the proposal has no impact on this guidance. For reference, it can be noted however that the relevant 50m radius area is currently made up of 56 HMOs out of 82 properties, a percentage of 68.29%. This proposal of course has no effect on that percentage and on its own merit the increase of 1 occupant in an area of such concentration of HMO is not considered to have a material effect. The HMO SPD also described a number of circumstances where new HMOs are considered not desirable, such as where they 'sandwich' single household dwellings between HMOs or create a number of HMOs next to each other. As this proposal does not involve the creation of a new HMO these considerations are not brought into effect.

- 5.5 The HMO use of this site currently benefits from a Licence granted by Portsmouth City Council to operate as an HMO with up to 7 occupants. This licence was granted on 20th June 2019.
- 5.6 The repurposing of internal rooms to accommodate the additional occupants within this proposal will have an effect on the ratio of communal/amenity space compared to private bedroom space available internally for future occupants. While this matter will also be considered as part of the necessary licensing of the HMO by the Private Sector Housing team under the Housing Act, the HMO SPD identifies this as a consideration as part of the assessment of whether a good standard of living environment is provided for future residents as required by Local Plan Policy PCS23. Under the current proposal the following room sizes would be provided, as compared to the minimum size prescribed in the Council's adopted guidance:

Room	Area Provided:	Required Standard:
Bedroom 1	12.81m ²	6.51m ²
Bedroom 2	10.01m ²	6.51m ²
Bedroom 3	10.84m ²	6.51m ²
Bedroom 4	10.03m ²	6.51m ²
Bedroom 5	10.24m ²	6.51m ²
Bedroom 6	11.44m ²	6.51m ²
Bedroom 7	10.52m ²	6.51m ²
Combined Living Space	26.95m ²	22.5m ²
Shower room 1 (SF)	3.75m ²	2.74m ²
Shower room 2 (FF)	3.74m ²	2.74m ²
WC (GF)	0.78m ²	1.17m ²

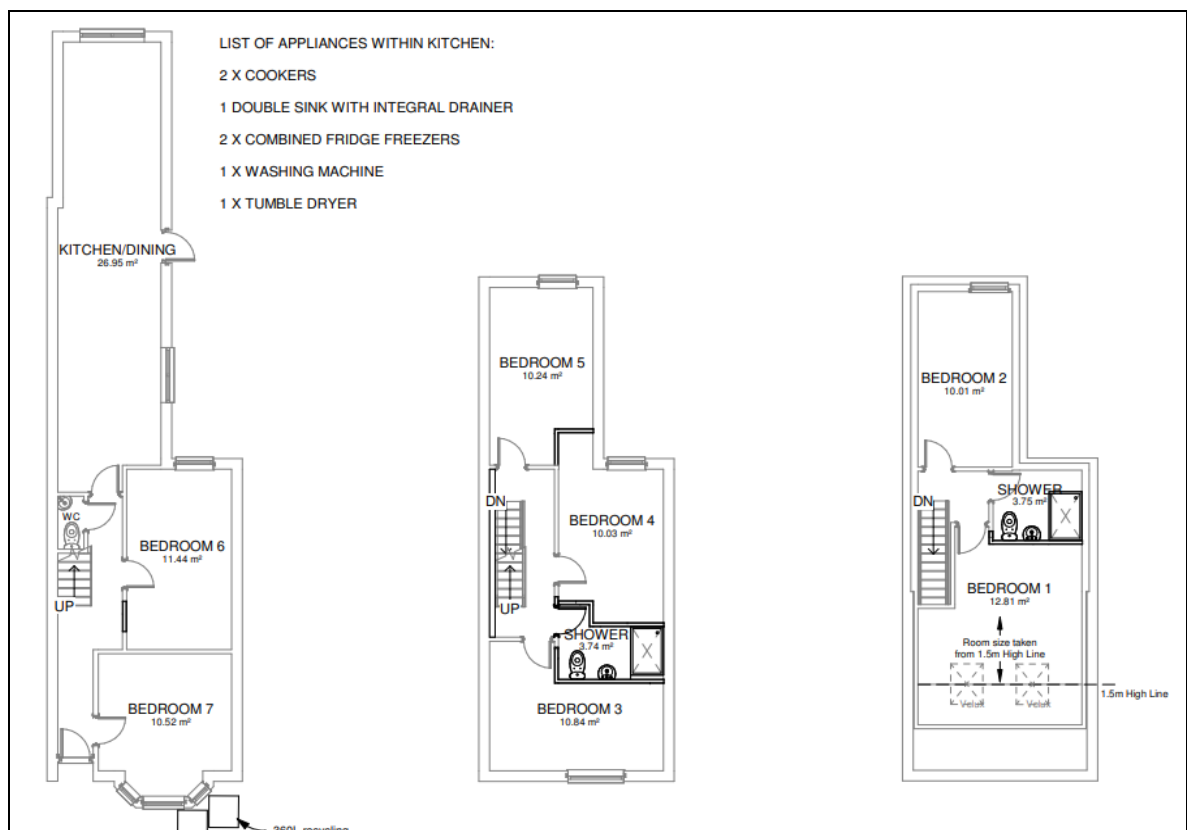

- 5.7 As is shown in the table above, the proposal results in an internal layout that meets a straightforward appraisal against the Council's adopted space standards except for the ground floor WC. The HMO SPD, at para 2.6, advises that more detailed guidance, beyond these headline requirements should be referred to within the Council's standards for Houses in Multiple Occupation Guidance (September 2018). This more detailed guidance applies lower minimum requirements (of 22.5m²) for combined living

accommodation in circumstances where all bedrooms are at least 10m² and the accommodation is otherwise acceptable as communal space. As noted that the WC at ground floor level is under the size standards, it is a restricted size however it is on-balance considered to be useable. It is noted that this layout has been licenced by the Private Sector Housing Team. On the basis of the information supplied with the application this detailed guidance is considered applicable and the resulting layout is considered to result in a satisfactory standard of living environment.

5.8 Amenity and Parking

5.9 The proposal would increase the occupancy of the existing HMO by 1 occupant. While this would have a proportionate increase in activity within and coming and going from the property this small increase in the number of residents is not considered likely to have any demonstrable adverse effect on residential amenity for neighbours of the surrounding area.

5.10 Similarly the minor increase of occupants is not considered to have a demonstrable impact on the parking need and thus parking availability in the wider area. It is noted that the Council's adopted Parking Standards, within the associated SPD has the same expectation for the number of parking spaces, 2 spaces per dwelling, for any scale of HMO with 4 or more bedrooms. Consequently, the proposal remains in accordance with the Council's adopted guidance on parking provision.

5.11 Other Material Considerations

5.12 A key and overriding consideration in this case is the necessity to recognise the fall-back position available to the applicant; that is the position they could take if this application is refused. In this case the addition of only 1 occupant to the existing lawful HMO is not considered to amount to a material change in the use of the dwelling. Under s57 Town and Country Planning Act 1990 ('TCPA') there is a general requirement that development should not to be carried out, except with planning permission. However not all changes of use are considered to be 'development' and therefore not all changes require planning permission. Under s55 of the Town and Country Planning Act 1990 'development' is defined as making of a *material* change in the use of any buildings or land. Whether or not a change is a material change is a matter of fact and degree to be assessed on its own merits. Members will note a number of joint appeal decisions, the 'Campbell Properties' appeal dated 29 April 2021, and the 'Lane' appeal decision dated 9 March 2023 wherein the Inspector considered a number of similar changes of use and, on their individual merits, identified examples whereby a change in the occupancy of an existing HMO with up to 6 occupants to an occupancy up to 7 occupants, and a change in occupancy from up to 6 occupants to an occupancy of up to 8 occupants was not considered to be a material change of use notwithstanding it moved the classification of the dwellings outside of Use Class C4 of the Use Classes Order. While every application must be considered on their own individual merits these examples provide clear guidance on the correct interpretation of s55 of the TCPA and that appeal decision is considered to be a material consideration in the determination of similar applications. Members may also note the previous decisions of Portsmouth's Planning Committee which have contrary to Officer recommendation determined similar changes in occupation amounted to a material change in use, primarily due to a conclusion that due to the intensity of the use of the accommodation; the impact on parking, waste, amenity impact upon neighbouring residents; and the impact on the solent special protection area the changes considered in those cases on their own individual merits amount to development requiring planning permission. The 'Lane' appeal decisions of 9 March 2023 where against three such Planning Committee decisions and the Planning Inspector in those case disagreed both with the judgement of the Committee and was critical of the justification, noted above, as a basis for that judgement.

5.13 In the circumstances of the case the subject of this report it is considered that the increase in occupancy does not result in a significant difference in the character of the

activities that would occur under the proposed occupation compared to the existing lawful use as a HMO with up to six occupants. As such it is considered that the change of use is not material and planning permission is not required for the increase in occupancy described in the application. The Applicant therefore has a fall-back position of being able to lawfully carry out the change in occupation without the benefit of Planning Permission.

- 5.14 Should it be considered necessary to assess the merits of the application, notwithstanding the advice of Officers' above, the Committee's attention is drawn to the current 5 year housing land supply position within Portsmouth. In any planning application, the decision-maker will need to 'balance' any harms identified due to the development against any benefits also arising. Principally, for this HMO application, the benefits are to the provision of housing through the provision of additional bedspace of occupation within the HMO. While this is a small contribution to the overall housing stock, the Council currently is unable to identify a 'five year supply' of housing, with only a 2.9 year supply currently identifiable. In this circumstance, the Council is directed to consider that the policies which are most important to determinations associated with housing provision within the Local Plan are out of date. The consequence of this is that decision takers are directed to apply a tilted balance to determinations so that permission is only withheld when the adverse impacts '*...significantly and demonstrably outweigh the benefits...*'. Any harm associated with the increase in occupancy in this area are considered to be insignificant and therefore fall short of being able to significantly and demonstrably outweigh even the small benefit to the city's housing stock of the provision of bedspaces, should such assessment be considered necessary.

5.15 Impact on Special Protection Areas

- 5.16 Whilst it is acknowledged that there are ongoing issues around the nitrification of the Solent due to increased levels of runoff from residential development. The applicants above fall-back position would allow the occupation of the site without Planning Permission. As such it is considered that the proposal would not amount to development and therefore not have Likely Significant Effect on the Solent Special Protection Areas or result in an increased level of nitrate discharge.

6.0 CONCLUSION

- 6.1 As detailed above the application is considered to fully comply with the relevant policies of the Local Plan. However notwithstanding the compliance or otherwise of the proposal with the policies of the Local Plan it is noted that on the details of this case the changes in the character of activities are not sufficiently significant, as a matter of fact and degree, to be considered to result in a material change in the use of this dwelling. As such planning permission is not required for the described in the application and the proposal could be carried out as a fall-back position irrespective of the determination of this application. This is considered a material consideration of overriding weight, and unconditional planning permission should therefore be granted.
- 6.2 Should the Committee conclude, contrary to this recommendation, that the change in occupation, as a matter of planning judgement, fact and degree in this specific case results in a material change of use requiring planning permission then they should consider whether permission should be granted with conditions. In such a circumstance, as the merits of the proposed use comply fully with the relevant policies of the Local Plan and associated guidance, the Committee would need to consider whether to resolve to grant permission, subject to the imposition of conditions requiring implementation of the additional occupancy within 1 year (a Time Limit condition), requiring that the development be carried out in accordance with plans submitted (an Approved Plans condition), and requiring that that increased occupancy should not occur until an appropriate scheme of mitigation is submitted and approved to mitigate any impact on the Solent Special Protection Area.

RECOMMENDATION

Unconditional Permission

Conditions: None